

**NAC**  
Newhampton Arts Centre



Campaign  
for  
Real Ale



MAIN FESTIVAL



**HOLDEN'S**

EST. 1915

SPONSOR

**THURS 6TH TO  
SAT 8TH JULY**

12 NOON - 10:30PM DAILY

**NEWHAMPTON ARTS CENTRE  
DUNKLEY ST. WV1 4AN**

**WOLVERHAMPTON**

*Summer festival  
of*

**BEER  
& CIDER**

REAL ALE FINDER



ON TAP NEAR YOU



Wolverhampton  
Campaign for Real Ale



# BEER FESTIVAL 2023

**SEPTEMBER**

**8TH - 5PM - 12**  
**9TH - 12PM - 12**  
**10TH - 12PM - 11**

**OVER  
20 REAL ALES  
VARIOUS CIDERS  
LIVE MUSIC  
HOT FOOD  
AVAILABLE**

**LIVE MUSIC**

**FRIDAY**

**9PM - 12 : THE PROJECT BLUES BAND**

**SATURDAY**

**3PM - 5 : ACOUSTIC SINGER - BEN FOLGER**  
**6PM - 8 : INDIE CLASSICS - THE 4AM GANG**  
**9PM - 12 : ROCK COVER BAND - EASTWOOD**

**SUNDAY**

**3PM ONWARDS - DJ MATT**



**10 MANOR ROAD, PENN, WOLVERHAMPTON, WV4 5PY**

**GET IN TOUCH: ENQUIRIES@PENNBOWLINGCLUB.COM OR 01902 342516**

**WOLVERHAMPTON**

*Summer festival  
of*

# BEER & CIDER

<b>Liquid Refreshment</b> Information on our drink availability	4
<b>Food &amp; Venue</b> What else will you find at the festival	5
<b>Cask Ale list</b> Local brewery news	12
<b>Cider, Perry &amp; Bar list</b> Branch pub news	16
<b>Venue &amp; Entertainment</b> What's lined up for Friday and Saturday + venue map	18
<b>Current Award Holders</b> Our branch area award winning pubs	22
<b>Festival Cause</b> Our chosen cause for 2023	25
<b>Our Branch</b> Wolverhampton CAMRA get out and about. See what we're about	26
<b>Thank You</b> Festival thanks given to friends and sponsors	27

## **Disclaimer**

This programme is published by the Wolverhampton branch of the Campaign for Real Ale Ltd. (CAMRA). The views or opinions expressed are not necessarily those of CAMRA or the editor.

**WELCOME**

## **WELCOME**

**Welcome to the 46th Wolverhampton Summer Festival of Beer and Cider.**

Wolverhampton is one of the longest running CAMRA festivals in the country.

We have a couple of beers brewed specially for this festival which we will all enjoy sampling.

The tombola this year is raising money for the Deanesly Centre at New Cross Hospital who produce care packages for chemotherapy patients.

We have our membership stall if anyone wishes to join CAMRA; ask about extras you may get for joining at the festival. We also have the CAMRA shop.

Thursday is our quiet night and on Friday evening and Saturday afternoon we have live music in the marquee.

Thank you for supporting the festival.

Cheers,

**Charlotte Coxon & Tim Deeming**  
Festival Organisers

## **ONLINE**

Want to access Wolverhampton CAMRA news and information digitally? Follow us on social media:

Facebook - WolverhamptonCAMRA  
Twitter - @WolvesCAMRA  
Instagram - @WolverhamptonCAMRA

Website - [www.wolverhampton.camra.org.uk](http://www.wolverhampton.camra.org.uk)

# LIQUID REFRESHMENT

We have a great line up of drinks available this year– from cask ales to craft cans, the best natural cider and perry and of course gin, as well as some bottled beers from across the world.

You'll find our drink selection in the beer hall and our cask ale list appears on page 20 of this programme. There may have been changes and additions, download the Real Ale Finder app and you'll find the live festival beer and cider list on there. The cider, perry and craft can list can also be found on page 16 of this programme.

Visit the craft can, bottle and gin bar on the day to discover what delights await there, on the left as you enter the beer hall.



## CONNECTING PUBS AND PEOPLE WHO LOVE REAL ALE, CRAFT BEER & CIDER

### Do you own or manage a pub?

We have a version of our app for pubs that can help you promote your real ale, craft beer, ciders & perries.

Features include: Inventory Management, Easy Social Sharing, Live Beer Board, Reports Suite, Tools and Downloads, TV Screen Support!

Getting started couldn't be easier. Simply download our pub app, fill in a few details and you'll be up and running in no time!



Live map showing pubs and beers

Comprehensive tasting notes

Real time notifications from your favourite pubs

Alerts when favourite beers are available nearby

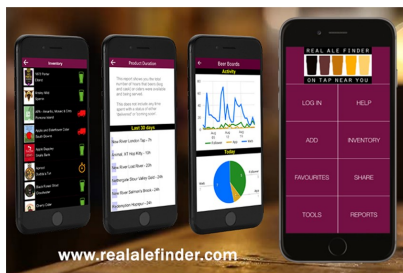

www.realalefinder.com

# FOOD AND VENUE

As well as a great selection of drinks to start your party, there's more to explore including entertainment, food, the tombola and our shop. Take a look around!

## **GOOD CAUSE - TOMBOLA STALL**

All of the proceeds from this year's tombola stall, together with donations of your unused beer tokens will go to Wolverhampton CAMRA's nominated good cause for 2023, the Deanesly Centre at New Cross Hospital - more about this on page 25.

## **CAMRA SHOP AND MEMBERSHIP STALL**

The shop stocks a wide range of CAMRA publications and merchandise. Why not consider joining CAMRA? Full details including **SPECIAL OFFER** for new members joining at this festival are available from the membership stand.

## **OUTDOOR DRINKING AREA**

As you are aware, smoking is not allowed anywhere within the confines of the Newhampton Arts Centre building, however, please rest assured that CAMRA Wolverhampton continues to offer a warm welcome to all customers. To this end, there is an outdoor drinking area where smoking will be allowed, in the area alongside the marquee.

## **FOOD**

The food available at this festival is provided by the NAC's on-site café. This is situated just along the main corridor from the beer hall. The café is bright and friendly; the tasty selection of food is affordable and is made fresh to order. Vegetarian options will be available and hot & cold drinks will also be on sale.

## **MUSIC & SEATING**

Our seated area is under the outdoor marquee, where Friday and Saturday's live entertainment will also appear. Grab a drink from the beer hall and find yourself a seat! Entertainment details can be found on page 18.

## DRINK AVAILABILITY

The listed cask ales (page 12) are subject to availability and may not be available at all sessions. For any amendments to the list, please check Real Ale Finder app where the live list will be available. Each beer will be offered for sale when our Bar Managers are satisfied that it has reached the quality which its brewer intended. Beers which are ready for sale will be identified by cards on the front of the cask. Please do not ask to try a beer which is not yet ready for sale, as this will not be permitted under any circumstances.

We have 2 beers brewed specially for our festival this year. Banks's 'KRPOW' and Kinver 'A Dave in the Life' brewed in memory of Dave Coxon, a long standing member of Wolverhampton CAMRA, who died earlier this year.

## OPENING HOURS

Wolverhampton's Summer Festival of Beer & Cider is open Thursday 6th July to Saturday 8th July, 12 noon to 10:30pm each day, with doors closing at 10:00pm.

# THE ROYAL OAK

<https://www.theoakchapelash.com/>

01902 422845



~REAL ALES

CASK MARQUE AND CAMRA AWARDED

~LIVE MUSIC

TUESDAYS AND FRIDAYS

~BAR SNACKS

COBS, SAUSAGE ROLLS, AND CRISPS

~COMMUNITY

SPORTS AND CHARITY SUPPORT



SUMMER FESTIVAL OF BEER & CIDER 2023

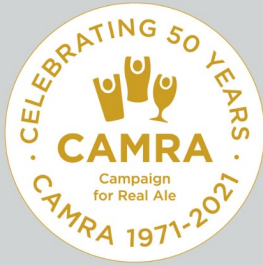

Find out more, and pre-order your copy now at [camra.org.uk/50-years/50th-anniversary-book/](http://camra.org.uk/50-years/50th-anniversary-book/)

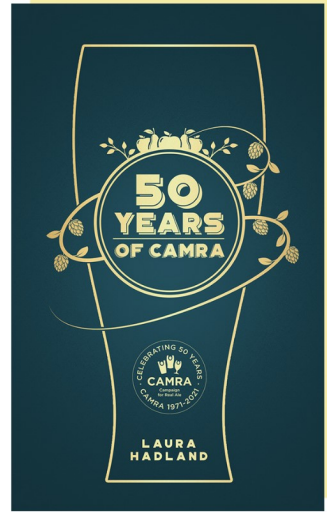

## HOGSHEAD

8 CASK PULLS  
6 CRAFT BEER LINES  
10+ LILLEYS CIDER FLAVOURS



MAGIC MONDAYS  
50P OFF ALL CASK ALES



10% OFF ALL CASK ALES FOR  
CAMRA MEMBERS TUES-SUN



BEAUTIFUL HIDDEN  
BEER GARDEN



186 STAFFORD STREET, WV1 1NA





# HALTON CASTLE BEER FESTIVAL

28th - 30th July 2023

Halton Castle, Runcorn, WA7 2BE

Over 30 ales from within 30 miles

Panoramic Views | Castle Ruins | Live Music

Food & Craft Stalls | Games | Pub Quiz

Historical Talks | Heritage Walks

[haltoncastlebeerfestival.co.uk](http://haltoncastlebeerfestival.co.uk)



# CAMPAIGNING for PUBS PINTS & PEOPLE

SINCE  
1971



The Campaign for Real Ale celebrates its 50th Anniversary in style with a retro-inspired T-shirt. Get yours today and help our campaign for pubs, pints and people!

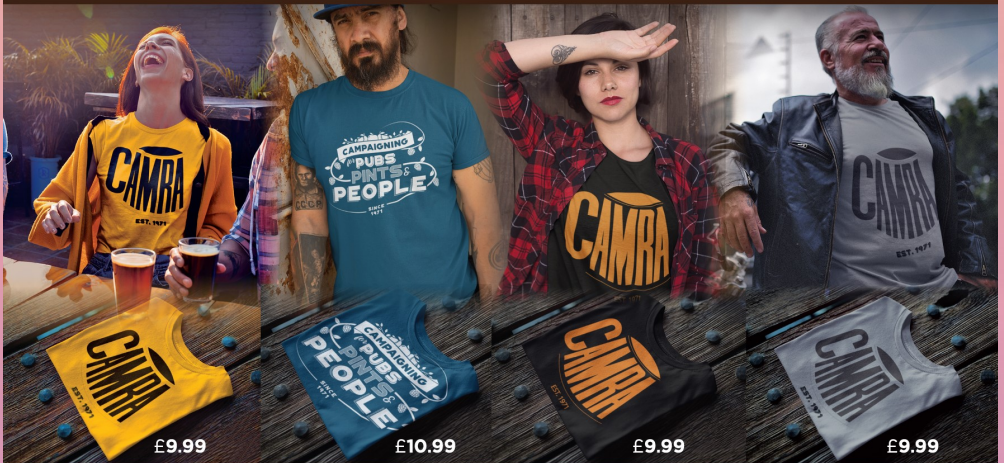

£9.99

£10.99

£9.99

£9.99



The official  
CAMRA biography  
available now!



Pin Badge and Pint Glass

Both £3.50 (+P&P)



[shop.camra.org.uk](http://shop.camra.org.uk)

**1-5 AUGUST**  
**OLYMPIA LONDON**

# GREAT BRITISH BEER FESTIVAL

THE LIVE BEER EXPERIENCE

**BOOK  
YOUR  
TICKETS**



# SIGNED WOLVES SHIRT RAFFLE

We're raffling off a Wolverhampton Wanderers shirt, as signed by the 2022 / 23 first team! The shirt has been donated to us by the club, as we raise money for our festival good cause, the **Deanesly Centre at New Cross Hospital**. See page 25 for details on our chosen cause!  
To take part in the raffle, visit the tombola in the Beer Hall and buy a ticket.



The shirt comes with a certificate of authenticity - try your luck for a chance to win a piece of Wolves history.

Good luck!

**PROUDLY SHIPPED**  
*From The Potteries*



TITANICBREWERY.CO.UK

# HAIL TO THE ALE

M I C R O P U B

*Ale House and Cider Tap*

2 Pendeford Avenue, Claregate, Wolverhampton, WV6 9EF.  
*on bus routes number 5 and 6*

## OPENING HOURS

WEDNESDAY to FRIDAY 5pm - 10pm

SATURDAY 12pm - 10pm

SUNDAY 12pm - 5pm

**6 Beers & 6 Ciders from £3.40 a pint**  
live beer board available at  
[www.hailtothealemicropub.co.uk](http://www.hailtothealemicropub.co.uk)  
with tasting notes and prices

## CAMRA DISCOUNT

20p off a pint of ale or draught cider  
Off peak only - Wednesday and Thursday

**SCOTCH EGG SATURDAYS**  
from 12pm Midday - 7 flavours

# CASK ALE

Note - contactless payment is available throughout the venue. Get the **Real Ale Finder** app (page 4) for live beer list.

WOLVERHAMPTON

Summer festival  
of

**BEER**  
& CIDER

## % DESCRIPTION

Ainsty Ales	Bantam Best	4.2	An Amber Ale with subtle Pear fruit and floral aromas, slightly sweet with a crisp bitter finish.
Ainsty Ales	Cool Citra	4.4	American Pale, single hopped & double dry-hopped with Citra.
Banks's <b>LocAle</b>	KRPOW	4.5	Dry hopped IPA with new a Slovenian hop called Krpan. Grapefruit citrus prominent with tropical and orange notes. Festival Special.
Burton Bridge <b>LocAle</b>	Damson Porter	4.5	Faint roast, caramel and dark fruit nose. Cough mixture and Blackjack beginning. Uncomplicated profile with a fractious mix of bitter fruitiness and yeasty maltiness.
Burton Bridge <b>LocAle</b>	Bramble Stout	5	Smoky aroma with a fruit hint. A roast start with briar dry fruit then a sharp blackfruit balances the burnt effect with a sweetish blackberry finish.
Byatts <b>LocAle</b>	Malt Maniac	5.8	A stunning malt driven Pale Ale, with sweet malty notes and subtle fruity hops.
Byatts <b>LocAle</b>	Mahanna	6	Brewed with New Zealand hops, an enticing aroma and copious amounts of bright citrus flavour, this IPA is sunshine in a glass.
Enville <b>LocAle</b>	Ginger	4.6	Golden bright with gently gingered tangs. A drinkable beer with no acute flavours but a satisfying aftertaste of sweet hoppiness.
Enville <b>LocAle</b>	Ale	4.5	Sweet malty aroma and taste, honey becomes apparent before bitterness finally dominates.
Firs Brewery <b>LocAle</b>	Rosetta Stone Mild	4.8	Dark, strong with delicious malt and chocolate flavours. Balanced by a light hoppy finish.
Fixed Wheel <b>LocAle</b>	No Brakes IPA	5.9	Deceptive citrus and hop IPA. So light in taste it belies it's gravity, with lots of lingering fruit and American hop flavours.
Fixed Wheel <b>LocAle</b>	Blackheath Stout	5	Full bodied stout brewed with New Zealand Pacific gem and English Brambling cross hops to give an okay bitterness and a big lush smooth creamy dark fruits finish.
Fownes <b>LocAle</b>	The Elephant Riders	4	This big, hoppy beer bursting with tropical fruit flavour now has even more Mosaic hops. NATURALLY HAZY/VEGAN.

Fyne Ales	Avalanche	4.5 the quintessential, refreshing pale ale showcasing Cascade and Liberty hops.
Fyne Ales	Jarl	3.8 A showcase for American hop, Citra, Jarl delivers waves of fruity citrus flavours and a clean finish.
Green Duck <b>LocAle</b>	Landslide	4.4 Citra & a tiny amount of Sabro, expect fresh tropical hoppy notes.
Green Duck <b>LocAle</b>	Bostin Mild	3.2 A deep malty flavour notes of caramel & subtle chocolate with aromas of vanilla and hazelnut. Low ABV but packed with flavour! VEGAN.
Green Duck <b>LocAle</b>	Session IPA	4 A Session IPA combining British Maris Otter malt with American Mosaic & Simcoe hops in a riot of blueberry, tangerine, papaya & passionfruit.
Holden's <b>LocAle</b>	Black Country Mild	3.7 Red brown mild with chocolate and roasted malt, rich and smooth.
Holden's <b>LocAle</b>	Summer Buzz	4.2 Seasonal golden ale with delicate honey hues, refreshing, light, smooth.
Kinver <b>LocAle</b>	Khyber	5.8 Award winning, true -to-style strong and bitter IPA brewed with Centennial hops.
Kinver <b>LocAle</b>	A Dave In The Life	4.6 To celebrate the life of Wolverhampton CAMRA member Dave Coxon. Pale, zesty, refreshingly hoppy golden ale. Brewed with FAB Four ingredients.
Limestone <b>LocAle</b>	Stone Faced	4 Pale and Dark Crystal Maris Otter malts unite, expect chewy toffee while fruits and berry flavours rush in. Styrian Goldings and Nugget Hops, pine & citrus flavours caress the taste buds.
Limestone <b>LocAle</b>	Cherry Stone	5.2 Biscuit pale malts provide the backdrop for this sumptuous fruit beer. Amoretti Cherries and Hersbrucker hops delicately combine.
Marston's <b>LocAle</b>	Old Empire	5.7 Malty and sweet to start, developing bitterness with fruit and a touch of sweetness. A balanced aftertaste of hops and fruit.
Newbridge <b>LocAle</b>	Little Fox	4.2 Brewed with English Maris Otter malted barley, and three varieties of English hops, Target, Goldings & Progress. An easy drinking amber bitter with complex earthy flavours.
Newbridge <b>LocAle</b>	Big Lizzie	5 A strong malty ruby mild.
Old Pie Factory <b>LocAle</b>	Pie In the Sky	4.1 A light pale ale with a hoppy refreshing taste an easy drinking beer

Old Pie Factory <b>LocAle</b>	Old Pie Factory Bitter	3.9	A modern bitter with traditional style. Smooth, well rounded, a malty nose and bitter finish.
Pennine	Scapegoat	4.2	Golden Ale. A delicate simple and refreshing beer that is hopped using one hop that provides a slightly citrus aroma, but gives a lovely creaminess mouthfeel.
Pennine	Pacific	4.1	New Zealand Pale. A light pale ale brewed using the finest New Zealand hops with tropical fruit characteristics and a mild citrus palate.
Purity <b>LocAle</b>	Mad Goose	4.2	Award winning zesty pale ale with smooth and citrus finish.
Redemption	Big Chief	5.5	Big hoppy IPA style beer, packed full of Kiwi hops with hints of honey and nectar and plenty of tropical citrus and floral notes.
Redemption	New Zealand Pale	4.6	Brewed with brand new New Zealand hop Superdelic expect big juicy mango, papaya and slight dark berry qualities, whilst Nectarons hops give passionfruit and guava notes.
Sarah Hughes <b>LocAle</b>	Dark Ruby	6	Balance of intense colour and dark fruit flavour make this mild a popular festival favourite.
Stewart	Stewart's 80/-	4.4	Auburn classic Scottish heavy, with malt and dried fruit on the nose and a smooth and creamy texture.
Tamworth <b>LocAle</b>	Whopper	6.5	Strong IPA-style golden ale with an assertive resinous hoppiness and a dry bitter finish.
Titanic <b>LocAle</b>	Iceberg	4.1	Yellow gold sparkling wheat beer with a flowery start leading to a great hop crescendo.
Trinity	Lichfield Pale Ale	4.3	Super sessionable pale with hints tropical fruits including passion fruit, Mellon and citrus.
Trinity	Lichfield Chocolate Stout	4.5	Rich dark and toasty with strong chocolate aroma and creamy chocolate finish.
Twisted Barrel <b>LocAle</b>	The Chance	4.2	A soft, juicy pale showcasing the tropical, piney qualities of the Mosaic and Vic Secret hop blend. NATURALLY HAZY/VEGAN.
Twisted Barrel <b>LocAle</b>	The Great Test	5.2	A dry, refreshing West Coast IPA with sticky resin and grapefruit flavour. Hopped with Azacca, Centennial and Chinook. NATURALLY HAZY/VEGAN.

# Campaigning *for you*

**Real ale is just the start...**

We support everything from **pubs and drinkers' rights**, to **licenses and breweries**, the list is endless. United in **the story** we all love, our **great tradition**.

## **So why not join us?**

Save on beer when you visit the pub with our voucher and discount schemes. Plus save on entry to 100s of beer festivals too, just a few perks of our CAMRA membership.

**Make our story part of yours.**

**Join at [camra.org.uk/join](https://camra.org.uk/join)**



Campaign  
for  
Real Ale

**Real stories, real people, real ale**



# CIDER & PERRY



## Cockeyed

### **Mad Jack** (5% ABV)

A delicious dry cider with an aftertaste of stewed apple.

## Dudda's Tun

### **Sweet Apple** (5.5% ABV)

Bursting with freshly picked apple flavour, this sweet cider is deliciously moreish with soft honey notes. Perfect for those with a slightly sweeter tooth.

## Dunkertons

### **Dry Organic** (6.8% ABV)

Carefully blended from a range of traditional cider apples which provide a crisper taste. Sharp, crisp and to the point. Pours with a red hued gold with a very slight haze. This cider is full-bodied with a short-lived fizz from a light carbonation leading to a slightly sparkling drier cider with a rustic cider apple feel.

## Farmer Jims

### **Strawberry & Kiwi** (4% ABV)

A light fruity cider with added Strawberry juice and sharp kiwi extract.

## Gwatkin

### **Yarlington Mill** (7% ABV)

Smooth and rich with a spirit aroma and taste that resonates with the taste buds to surprise and delight. Would be an excellent substitute for a dessert wine.

## Newton Court

### **Panting Partridge Perry** (5.3% ABV)

Made with Perry pears handpicked by Pauls cousin from orchards from Yarkhill to Much Marcle. Medium with a juicy pear taste and delicate wine finish.

## Nightingale

### **Falstaff Bramley** (5.4% ABV)

Our classic Kentish cider, a refreshing and crisp blend with balanced acidity that shows off the Falstaff and Bramley apples. Medium dry still cider 2019 vintage.



## **Pulp**

### **Rhubarb (4% ABV)**

Rhubarb Cider....all pulp, no fiction! This craft medium cider is made the way all ciders should be... from pure juice. Delicately flavoured with genuine Yorkshire rhubarb to create a refreshing zingy cider where the fruit tastes as it should - from Yorkshire!

## **Purbeck**

### **Bushey Berry (4% ABV)**

Bushey Farm is home to plenty of berry bingers, thankfully there's enough left to freshly press into Bushey Berry - an expertly balanced cider with a punchy apple flavour and British berry kick.

## **Tolchards (formerly Moles)**

### **Black Rat Vintage (6% ABV)**

A strong dry premium blend cider full of flavour with a clean apple bite.

### **Black Rat Perry (6.8% ABV)**

Traditional Somerset Perry with a true pear aroma starts with a medium sweet taste and is followed by a dry finish.

# **CRAFT CANS & BOTTLES**

## **German:**

Tegernsee Hell (5.6%)

Fruh Kolsch (4.8%)

Ayinger Altbairisch Dunkel (5%)

Ayinger Lager Hell (4.9%)

Paulaner Hefe Hell (Weiss) (5.5%)

## **Belgian:**

Boon Kriek (Cherry Lambic 4.5%)

Boon Framboise (Raspberry 5%)

Golden Carolus Classic (8.5%)

## **UK:**

Tynt Meadow English Trappist (7.4%)

Arbor - Galazacca (IPA, 6.2%)

Arbor - Helles Lager (4.2%)

Arbor - Wish You Were Beer (Gluten Free, AF 0.5%)

Brew By Numbers vs Northern Monk - 55 DIPA 10 Hop (DIPA 8%)

Deya - Hokum Stomp (Porter, 5.6%)

Fixed Wheel - Big Mig (Saison 6.2%)  
- Wheelie Pale (4.1%)

Mondo Brewing - Gooseberry With Benefits (Sour 4.2%)

Otherworld - Wild Table Beer (Barrel aged table beer 3.5%)

Queer Brewing - Tiny Dots (Pilsner Lager 4.5%)

Sureshot - Jabroni (Tettninger Lager 4.8)

Verdant - Off Planet (NEIPA 6.5%)

# VENUE & ENTERTAINMENT

Friday 7th July (evening):

## THE NEW RUFFIANS

A band of multi instrumentalists, much loved in Wolverhampton and beyond, the New Ruffians play a blend of traditional Celtic punk, vintage ska & leftfield folk, a mixture of their own material along and inspirational classics from the genres.

Saturday 8th July:

## JAKE REES

From country and rock to blues, jazz and pop, Jake Rees isn't known as the 'human jukebox' for nothing!

## THE UKEING WOLVES

A festival favourite, expect pop, blues, soul and traditional ukulele music.

## THE BARLEY BEATS

An acoustic band originating from the Barley Mow, Penn, that plays a variety of material including 1960s style pop and folk songs. Their second appearance here.

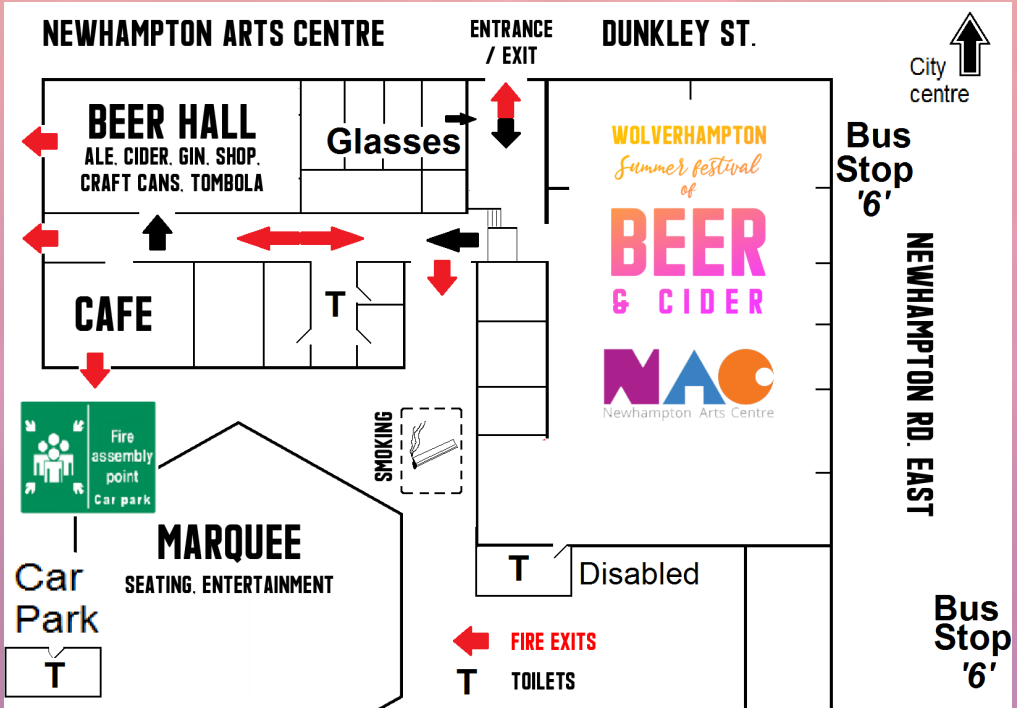

The  
SwanHotel  
Brewwood  
Staffs ST19  
9BS 01902850330



**CAMPAIGN  
FOR  
REAL ALE**



**CASK  
MARQUE**  
THE SIGN OF A GREAT PINT  
INDEPENDENTLY INSPECTED

We are proud to be CAMRA  
South Staffordshire pub of  
the year 2023

We are a Cask Marque  
recognised pub

**BEER & CELLAR  
HYGIENE RATING**



1P 2P 3P 4P 5P  
EXCELLENT

The Swan is a traditional country pub situated in the centre of the beautiful village of Brewwood serving cask ales, lagers, ciders, fine wines and spirits. Skittle alley, function room for hire. Dog and children friendly

**S**ome pubs have a wonderful atmosphere 🍻 Some pubs have a unique character 🍻 Some pubs have superb locally brewed real ales 🍻 Some pubs have friendly locals 🍻 Some pubs have a national ‘must visit’ reputation 🍻 Some pubs have genuine period interiors just like the old days 🍻 Some pubs have fascinating memorabilia 🍻 Some pubs have great bar staff 🍻 Some pubs have regulars that travel from the other end of the country 🍻 Some pubs have delicious locally sourced food 🍻 Some pubs have a story or two to tell 🍻 Some pubs have historic links going back to Victorian times 🍻 Some pubs have multiple CAMRA awards 🍻 Some pubs have cosy snugs 🍻 Some pubs have function rooms 🍻 Some pubs have cosy open fires in the winter 🍻 Some pubs have an outdoor sun-trap in the summer 🍻 Some pubs have afternoon tea 🍻 Some pubs have a dog-friendly policy 🍻 Some pubs have Grade II listed status 🍻 Some pubs have a 2 minute walk to the train station 🍻 Some pubs have a loyal and dedicated following 🍻 Some pubs have a place in your soul.

**One pub has it all.**



# LocAle

CAMRA's LocAle initiative promotes pubs stocking locally brewed real ale in order to reduce the number of 'beer miles' from brewery to pub cellar in response to growing consumer demand for quality local produce.

We carry the LocAle initiative forward to our Summer Festival of Beer & Cider, you'll see the LocAle logo appearing alongside cask ale that is from a local brewery (page 12) - this year the majority of our ales. We define 'local' as being within 30 miles of the festival boundary, the same as we do for LocAle accredited pubs.

Find out more about LocAle accreditation at:

<https://camra.org.uk/beer-and-cider/beer/locale/>

Choose Wolverhampton's  
No.1 for Vehicle Rental.

**TCHire**  
Vehicle Rental

Going the ~~extra~~ mile...

NEW  
Welfare  
Rental



Get an Instant Quote & Book Online:

[www.TCHire.co.uk](http://www.TCHire.co.uk) • or call 01902 420204

5 Penn Road, Wolverhampton, WV2 4ET (just 2 mins drive from this location)

Connect with us  

Cars • Vans • Minibuses • Welfare Vehicles • Utility Vehicles • Daily Rental • Flexi Hire • Contract Hire

## Wolverhampton CAMRA's City, South Staffs, Club and Cider Awards 2023

By January's end, Wolverhampton CAMRA members will have submitted their votes for which pubs go into CAMRA's Good Beer Guide 2024. Our branch is allocated slots for both Wolverhampton city area and our South Staffordshire branch area in the guide to represent those pubs, chosen by our members, as consistently offering the best quality real ale for the previous 12 months.

We'll have to wait for the Guide's publication on 28th September to find out who made this year's cut, but the voting also produces our shortlist for our Wolverhampton City Pub of the Year 2023, Country Pub of the Year 2023, Club of the Year 2023 and Cider Pub of the Year awards, all of which were awarded recently.

The country award covers those pubs in our branch's portion of South Staffs. The pubs receiving the most votes become the finalists and during February volunteer judges will visit and score them according to CAMRA's national pub of the year criteria:

- Quality of Beer/Cider/Perry
- Style, Décor, Furnishing and Cleanliness
- Service, Welcome & Offering
- Community Focus and Atmosphere
- Alignment with CAMRA Principles
- Overall Impression

Winners go forward to the West Midlands County and Staffordshire pub of the year competitions.

We also vote for our Club of the Year and Cider Pub of the Year. In the cider category, those receiving the most votes will become finalists where they too will be visited by volunteers judging them against the national cider pub of the year criteria (same as before minus quality of beer).

Below are our 2023 winners:

City Pub of the Year 2023 - **Keg & Comfort micropub** (Oxley)  
Runner-up: **The Starting Gate** (Pennfields)

Country Pub of the Year 2023 - **The Swan** (Brewood)  
Runner-up: **Love & Liquor** (Codsall)

Club of the Year 2023 - **The Firs Club** (Codsall)  
Runner-up: **Penn Bowling Club**

Cider Pub of the Year 2023 - **Keg & Comfort micropub** (Oxley)  
Runner-up: **Hail to the Ale** (Claregate)



# 50 years of celebrating Good Beer, Good Pubs and Good Times

New edition  
with regional  
introductions by  
award-winning  
beer writer  
**Laura Hadland**

sponsored by

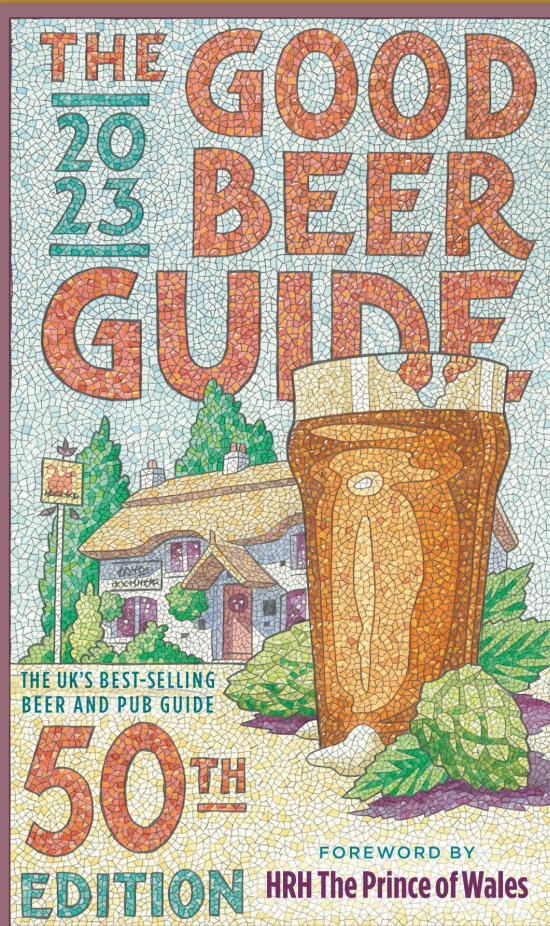

Cover art by  
**Neil Gower**

Available to order now from the CAMRA shop  
*member discounts apply*

RRP: **£16.99**

**Shop1.camra.org.uk**





# It's Festival Season

CAMRA beer festivals are ready  
to welcome you back!



Find your local  
CAMRA beer festival  
[camra.org.uk/festivals](https://camra.org.uk/festivals)





## The Deanesly Centre, New Cross Hospital

## The Royal Wolverhampton NHS Trust

Our chosen good cause for 2023 is the **Deanesly Centre at New Cross Hospital**. The Deanesly Centre treats cancer patients and produces care packages for chemotherapy patients.

You'll find our festival tombola in the beer hall, so try your luck at winning one of the many fabulous donated items and supporting the wonderful work of staff at the Deanesly Centre.

The Deanesly Centre is a purpose built centre that opened in June 1996 and is built around an open courtyard within the grounds of New Cross Hospital.



The centre serves a population of one million, covering Wolverhampton, Dudley, the Wyre Forest, Walsall and part of South Staffordshire.



## Ales Ciders Fruit Wines Cocktails

- Pub of the Year Wolverhampton 2023
- Cider Pub of the Year Wolverhampton 2023
- Runner Up for Regional Cider Pub of the Year 2023

### OPENING HOURS:

**Thursday:** 18:00 - 22:00 **Friday:** 17:00 - 22:00

**Saturday:** 15:00 - 22:00 **Sunday:** 13:00 - 18:00

474 Stafford Road, Wolverhampton WV10 6AN

T: **07952 631032** E: [live@kegandcomfort.co.uk](mailto:live@kegandcomfort.co.uk)

[www.kegandcomfort.co.uk](http://www.kegandcomfort.co.uk)



## NEVER A DULL MOMENT

Whether we're working to save a pub, promoting good beer and cider or simply out on a branch social, there's never a dull moment at the Wolverhampton Branch of the Campaign for Real Ale.



This year we've presented awards to the top pubs and clubs in our area as voted for and judged by volunteer members, we've celebrated Mild ale as we hosted the West Midlands Regional Mild in May trail back in May. We've taken part in quizzes and socials alongside neighbouring branches and we've got out and about to support our area pubs and local brewers and neighbouring branch festivals.

Wolverhampton CAMRA is a bit of an institution in these parts. We've been about since our first branch meeting on Thursday 25th November 1976 at the Clarendon Hotel, Chapel Ash. This is our 46th Beer & Cider festival, only halted by the pandemic in 2020 and 2021. Some of our current members were there right at the beginning and we'll see new members signing up during this festival.



Come and say hello to our members, all volunteers who you'll find working at the festival and, if you decide to sign up, we look forward to talking to you about some unique benefits for new members - details will be available during the festival.

# THANK YOU

This festival is organised and staffed by CAMRA members who give their time on a voluntary basis and without them this event would not happen.

Special thanks to **Holden's Brewery** for their valued support with our Festival programme, promotional beer mats, glasses stock and social media support.

The organising committee would also like to thank the following organisations and individuals for their greatly valued help and support:

The management and staff of **Newhampton Arts Centre**.

Tom Silcock & Fan Franklin from the *Lych Gate Tavern* who have hosted our planning meetings this year.

**Banks's Brewery; Danielle & Mark at MD Signs, Barton-upon-Humber; Chris Brown; Alex Chilton; Mike Franklin; Steve Hermon; Ian Hughes; Dave & Carol Kelly of Kinver Brewery; Abi Kemp; Jasbir S. Sanghera and Simon Yates.**

All our advertisers and sponsors, all who donated tombola prizes and all those too numerous to mention who gave freely of their time and energy to ensure the festival happened.

Special thanks go to our printers, **Wombourne Printers Ltd**.

**And finally, a big thank you to all our customers for coming and making this festival a success!**

Programme edited by Neil Hodgkiss

Programme printed by Wombourne Printers Ltd, Smestow Bridge Industrial Estate, Bridgnorth Rd, Wombourne, Wolverhampton WV5 8AY

© 2023 Wolverhampton Branch of Campaign for Real Ale

Views expressed in this programme are not necessarily those of CAMRA Ltd or the editor.





**PURE BLACK COUNTRY.**

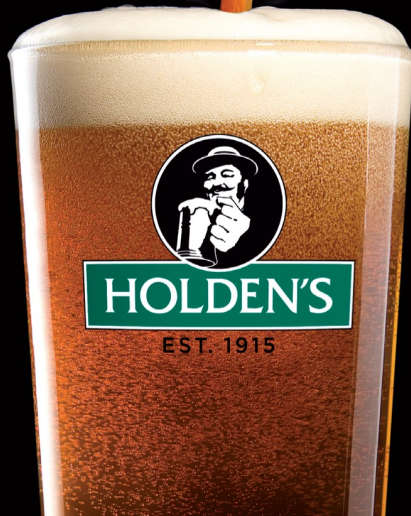

HOLDEN'S BREWERY IS PROUD TO SPONSOR THE WOLVERHAMPTON BEER FESTIVAL